

MANUAL WATER PUMP ASSEMBLY

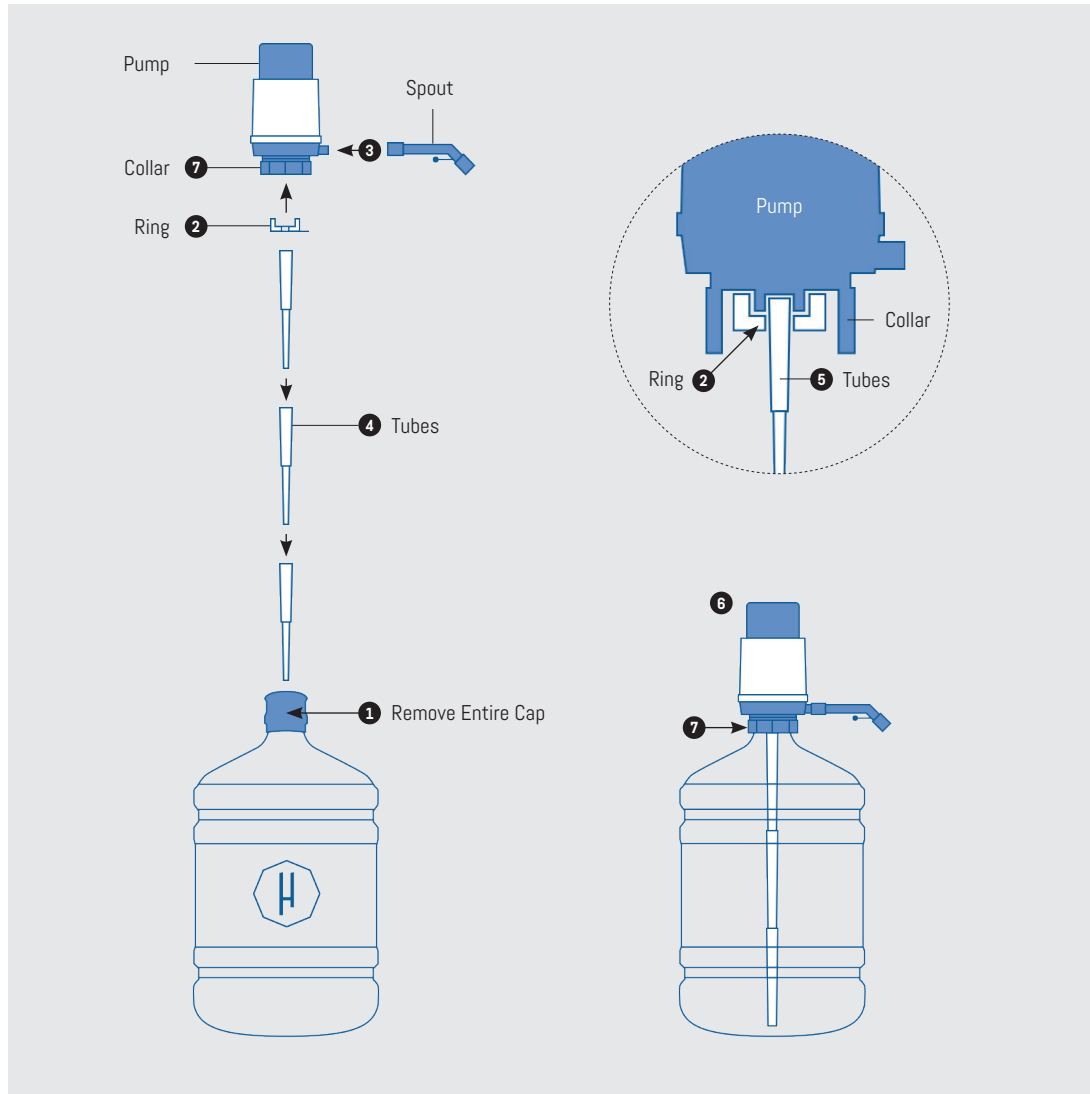

Prepare Bottle

1. Remove entire cap from your 5 gallon bottle of Hallstein Water

Assemble Pump

2. Slot **Ring** into the bottom of the collar until it snaps into place
3. Attach **Spout** to **Pump**
4. Assemble the three **Tubes** by pushing sections together
5. Attach assembled Tubes into **Ring** at the bottom of the Pump
6. Insert Assembled Pump into Bottle
7. Turn **Collar** to secure Pump to Bottle

Use

- Place cup, glass or pitcher under spout
- Press down on top of pump several times to make water flow
- Enjoy your Hallstein Water

Cleaning and Care

- Clean pump with a cloth, mild dishwashing soap and water
- Clean tubes and spout in dishwasher
- Store disassembled in a clean, dry location

Need more help?

Watch a video of how to assemble the pump on our website:
<https://www.hallsteinwater.com/our-water/faq>

